

TIG Machine Torches "ABITIG® MT"

air and liquid cooled

The compact designed machine torches of the ABITIG®-MT series represent an effective solution for welding operations with simple geometries.

With a wide range of current options, the torches are available in both air and liquid cooled options, with side mounted cable assemblies.

- Compact in design
- Rugged cable assemblies suitable for all established welding machines
- Ideally suited for welding operations with simple geometries



ABITIG® 150 MT

ABITIG® 260 W MT

ABITIG® 150 MT

Technical data (EN 60 974-7):

Type of cooling:	air cooled
Rating:	150 A DC 110 A AC
Duty cycle:	60%
Tungsten electrodes:	Ø 1.0-3.2 mm

ABITIG® 260 W MT

Technical data (EN 60 974-7):

Type of cooling:	liquid cooled
Rating:	260 A DC 180 A AC
Duty cycle:	100%
Tungsten electrodes:	Ø 1.0-3.2 mm

Torch complete			Torch body	
Type	Cooling	Part-No.	Type	Part-No.
ABITIG® 150 MT	air cooled	see comment ¹	Standard; 214.0 mm	778.1020
ABITIG® 260 W MT	liquid cooled	see comment ¹	Standard; 214.0 mm	779.1020

¹ Due to the highly differing types of connections on the machine side we cannot list order numbers for complete torches. For the order of complete torches please indicate the cable assembly length and the machine side connection.

ABITIG® 150 MT, ABITIG® 260 W MT

Wear parts



Guide tube (1 pc.)

779.1030

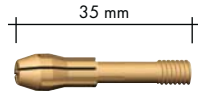

Electrode holder

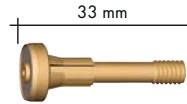

Gas diffuser

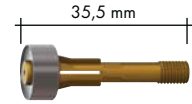

Gas diffuser

Electrode holder / Gas diffuser (5 pcs.)

Ø 1.0 mm	776.0061	776.0171	777.0171.5
Ø 1.6 mm	776.0062	776.0172	777.0172.5
Ø 2.0 mm	776.0067	776.0177	777.0177.5
Ø 2.4 mm	776.0063	776.0173	777.0173.5
Ø 3.2 mm	776.0064	776.0174	777.0174.5



Insulator (1 pc.)

779.1043



Standard version



Ball version

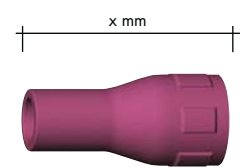

Long version

Gas nozzle, ceramic
(10 pcs.)

			x = 36 mm	x = 60 mm
Ø 6.5 mm	777.0081	770.0081.10	777.2171	777.2175
Ø 8.0 mm	777.0082	770.0082.10	777.2172	777.2176
Ø 9.5 mm	777.0083	770.0083.10	777.2173	-
Ø 11.0 mm	777.0084	770.0084.10	777.2174	-

TIG Automatic Welding Torches ABITIG® 150 MT

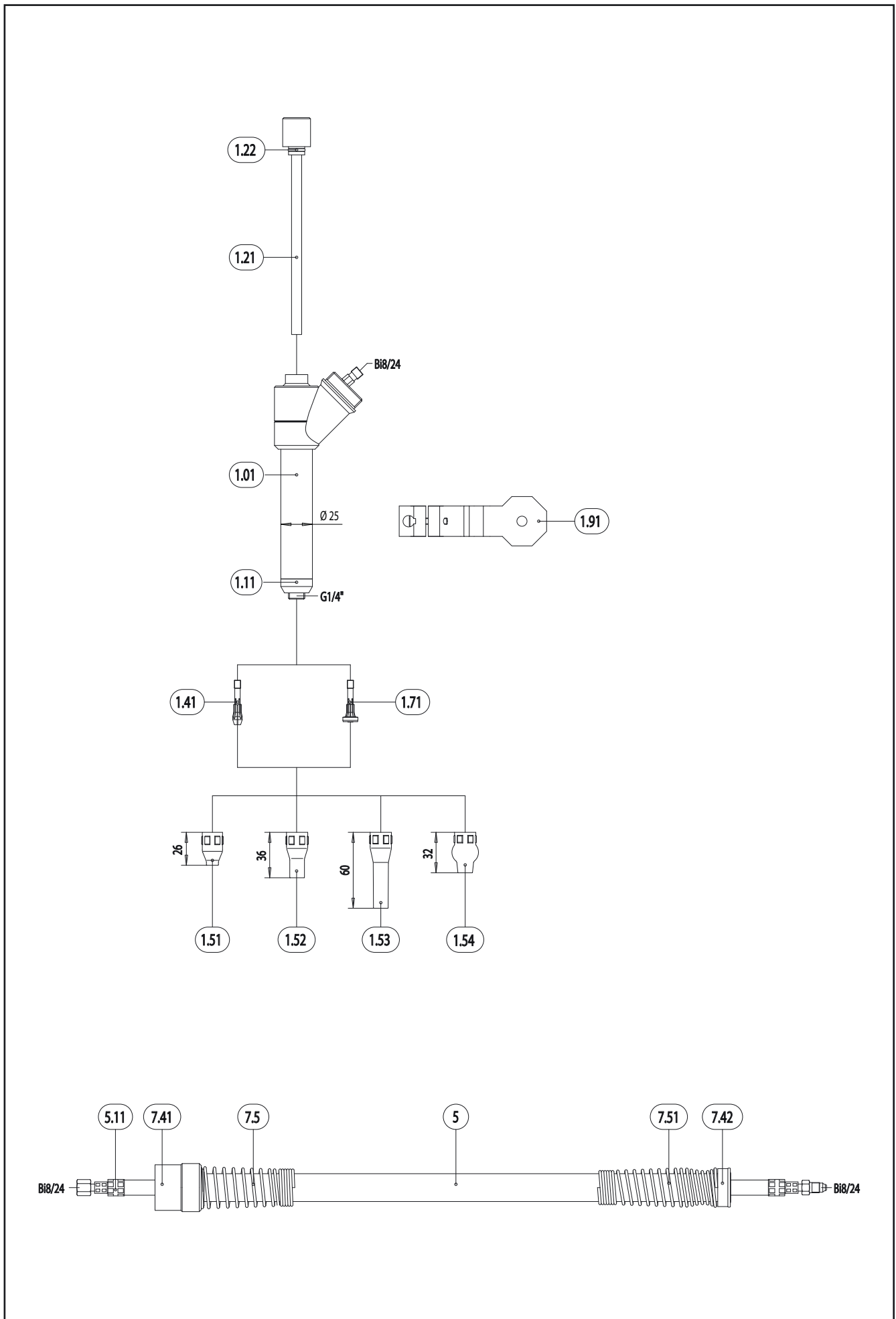

TIG Automatic Welding Torches ABITIG® 150 MT

Pos.	Description	Units	Part-No.	Product-group
	Torch body			
1.01	Torch body ABITIG® 150 MT		778.1020	2532
1.11	Insulator		779.1043	2555
1.21	Guide tube cpl. ABITIG® 150 MT / ABITIG® 260 W MT		779.1030	2555
1.22	O-Ring 9x2	20 Pcs.	165.0030	9010
	Wear parts			
1.41	Electrode holder for electrode WE Ø 1.0 mm	5 Pcs.	776.0061	2548
1.41	Electrode holder for electrode WE Ø 1.6 mm	5 Pcs.	776.0062	2548
1.41	Electrode holder for electrode WE Ø 2.0 mm	5 Pcs.	776.0067	2548
1.41	Electrode holder for electrode WE Ø 2.4 mm	5 Pcs.	776.0063	2548
1.41	Electrode holder for electrode WE Ø 3.2 mm	5 Pcs.	776.0064	2548
1.51	Ceramic gas nozzle 26 mm; ND 6.5 mm	10 Pcs.	777.0081	2541
1.51	Ceramic gas nozzle 26 mm; ND 8.0 mm	10 Pcs.	777.0082	2541
1.51	Ceramic gas nozzle 26 mm; ND 9.5 mm	10 Pcs.	777.0083	2541
1.51	Ceramic gas nozzle 26 mm; ND 11.0 mm	10 Pcs.	777.0084	2541
1.52	Ceramic gas nozzle 36 mm; ND 6.5 mm	10 Pcs.	777.2171	2541
1.52	Ceramic gas nozzle 36 mm; ND 8.0 mm	10 Pcs.	777.2172	2541
1.52	Ceramic gas nozzle 36 mm; ND 9.5 mm	10 Pcs.	777.2173	2541
1.52	Ceramic gas nozzle 36 mm; ND 11.0 mm	10 Pcs.	777.2174	2541
1.53	Ceramic gas nozzle 60 mm; ND 6.5 mm	10 Pcs.	777.2175	2541
1.53	Ceramic gas nozzle 60 mm; ND 8.0 mm	10 Pcs.	777.2176	2541
1.54	Ceramic gas nozzle 32 mm; ND 6.5 mm	10 Pcs.	770.0081.10	2541
1.54	Ceramic gas nozzle 32 mm; ND 8.0 mm	10 Pcs.	770.0082.10	2541
1.54	Ceramic gas nozzle 32 mm; ND 9.5 mm	10 Pcs.	770.0083.10	2541
1.54	Ceramic gas nozzle 32 mm; ND 11.0 mm	10 Pcs.	770.0084.10	2541
1.71	Gas diffuser for electrode WE-Ø 1.0 mm		776.0171	2548
1.71	Gas diffuser for electrode WE-Ø 1.6 mm		776.0172	2548
1.71	Gas diffuser for electrode WE-Ø 2.0 mm		776.0177	2548
1.71	Gas diffuser for electrode WE-Ø 2.4 mm		776.0173	2548
1.71	Gas diffuser for electrode WE-Ø 3.2 mm		776.0174	2548
	Accessories			
1.91	Torch mount MT-25		780.0222	2555
	Cable assembly			
5	Hose 9 black Ø 18.2x1.25	60 m	109.0019	4050
5.11	Power cable High Flex (ABITIG® MT) for 4.00 m		150.0175	2555
7.41	Strain relief ERGO		400.0412	9010
7.42	Strain relief		500.0252	9010
7.5	Cable support spring		775.1341	2555
7.51	Cable support spring		500.0226	9010

TIG Automatic Welding Torches ABITIG® 260 W MT

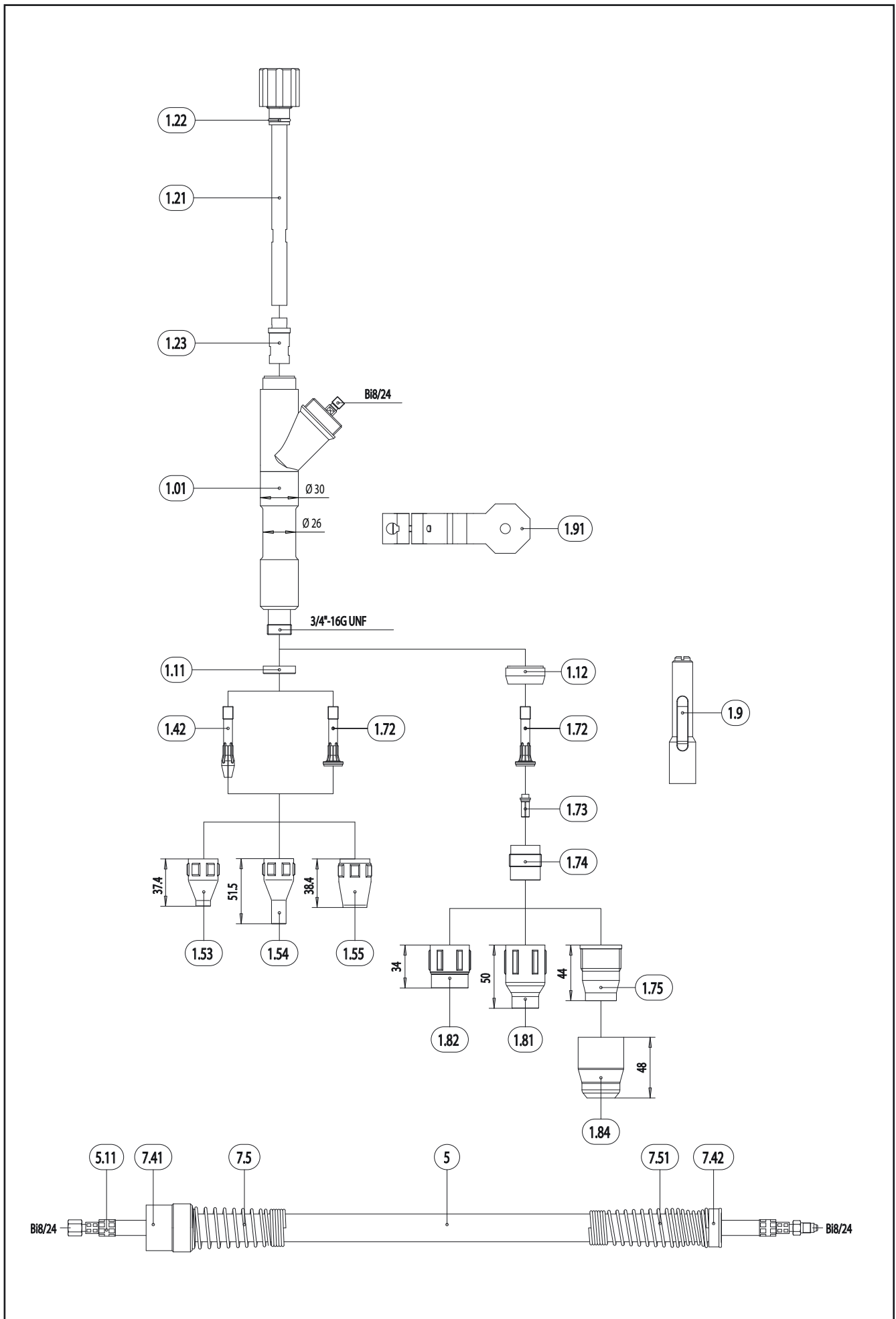

TIG Automatic Welding Torches ABITIG® 260 W MT

Pos.	Description	Units	Part-No.	Product-group
	Torch body			
1.02	Torch body ABITIG® 260 W MT		779.1020	2532
1.11	Insulator		779.1043	2555
1.21	Guide tube cpl. ABITIG® 150 MT / ABITIG® 260 W MT		779.1030	2555
1.22	O-Ring 9x2	20 Pcs.	165.0030	9010
	Wear parts			
1.41	Electrode holder for electrode WE Ø 1.0 mm	5 Pcs.	776.0061	2548
1.41	Electrode holder for electrode WE Ø 1.6 mm	5 Pcs.	776.0062	2548
1.41	Electrode holder for electrode WE Ø 2.0 mm	5 Pcs.	776.0067	2548
1.41	Electrode holder for electrode WE Ø 2.4 mm	5 Pcs.	776.0063	2548
1.41	Electrode holder for electrode WE Ø 3.2 mm	5 Pcs.	776.0064	2548
1.51	Ceramic gas nozzle 26 mm; ND 6.5 mm	10 Pcs.	777.0081	2541
1.51	Ceramic gas nozzle 26 mm; ND 8.0 mm	10 Pcs.	777.0082	2541
1.51	Ceramic gas nozzle 26 mm; ND 9.5 mm	10 Pcs.	777.0083	2541
1.51	Ceramic gas nozzle 26 mm; ND 11.0 mm	10 Pcs.	777.0084	2541
1.52	Ceramic gas nozzle 36 mm; ND 6.5 mm	10 Pcs.	777.2171	2541
1.52	Ceramic gas nozzle 36 mm; ND 8.0 mm	10 Pcs.	777.2172	2541
1.52	Ceramic gas nozzle 36 mm; ND 9.5 mm	10 Pcs.	777.2173	2541
1.52	Ceramic gas nozzle 36 mm; ND 11.0 mm	10 Pcs.	777.2174	2541
1.53	Ceramic gas nozzle 60 mm; ND 6.5 mm	10 Pcs.	777.2175	2541
1.53	Ceramic gas nozzle 60 mm; ND 8.0 mm	10 Pcs.	777.2176	2541
1.54	Ceramic gas nozzle 32 mm; ND 6.5 mm	10 Pcs.	770.0081.10	2541
1.54	Ceramic gas nozzle 32 mm; ND 8.0 mm	10 Pcs.	770.0082.10	2541
1.54	Ceramic gas nozzle 32 mm; ND 9.5 mm	10 Pcs.	770.0083.10	2541
1.54	Ceramic gas nozzle 32 mm; ND 11.0 mm	10 Pcs.	770.0084.10	2541
1.71	Gas diffuser for electrode WE-Ø 1.0 mm		776.0171	2548
1.71	Gas diffuser for electrode WE-Ø 1.6 mm		776.0172	2548
1.71	Gas diffuser for electrode WE-Ø 2.0 mm		776.0177	2548
1.71	Gas diffuser for electrode WE-Ø 2.4 mm		776.0173	2548
1.71	Gas diffuser for electrode WE-Ø 3.2 mm		776.0174	2548
	Accessories			
1.91	Torch mount MT-25		780.0222	2555
	Cable assembly			
5	Hose 10 black Ø 22x1.25	40 m	109.0020	4050
5.14	Power cable High Flex (ABITIG® MT) for 4.00 m		150.0175	2555
5.2	Hose Ø 3x1.5	100 m	102.0124	4050
5.3	Hose 49 black Ø 3.9x1.5	40 m	109.0059	4050
5.4	Hose clamp Ø 6.2 mm with ring (mark 6.6)	20 Pcs.	173.0006	9010
5.5	Hose clamp Ø 7.5 mm with ring (mark 8.0)	20 Pcs.	173.0007	9010
7.41	Strain relief		400.0413	9010
7.5	Cable support spring		775.1341	2555
7.51	Cable support spring		500.0227	9010